

SBI-HL/HLS/HLL

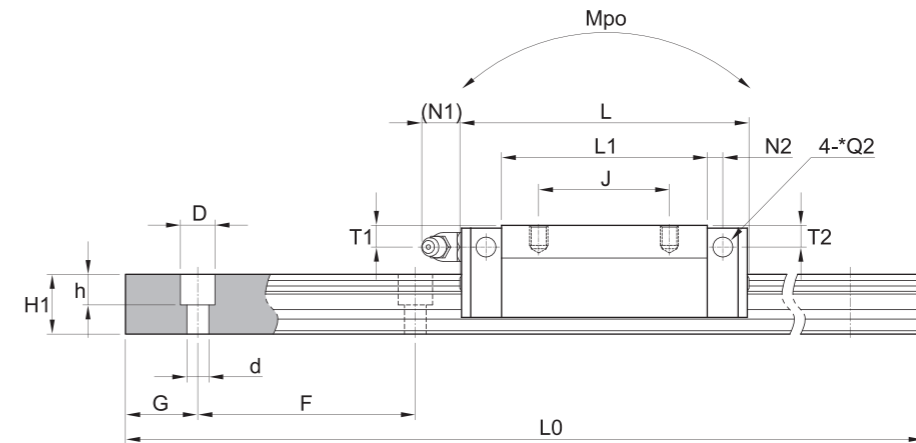
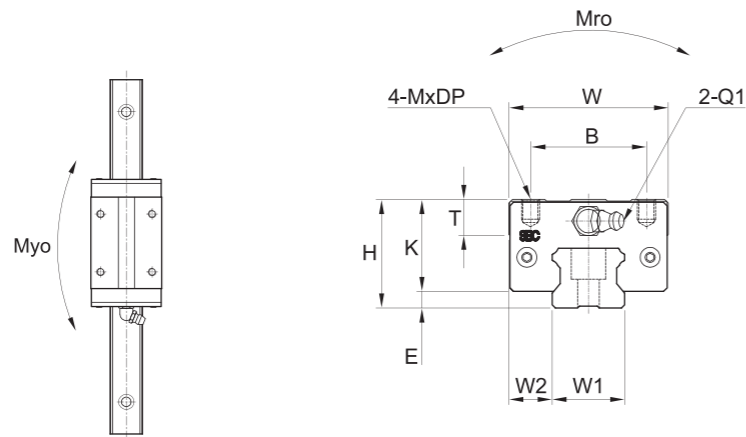

(单位Unit : mm)

型号 Model	安装尺寸 Mounting dimension				滑块尺寸 Block dimensions												
	H	W	L	E	安装螺纹孔 Mounting tap hole				L1	T±1	K	注油部件 Grease fitting					
					B	J	M	DP				T1	N1	T2	N2	Q1	*Q2
SBI15 HL	24	34	63.8	3	26	26	M4	4	45.2	6	21	4.5	5.5	3.8	3.8	M4x0.7	Ø3.5
SBI15 HLS	24	34	56.8	3	26	26	M4	4	38.2	6	21	4.5	5.5	3.8	3.8	M4x0.7	Ø3.5
SBI15 HLL	24	34	79.4	3	26	34	M4	4	60.8	6	21	4.5	5.5	3.8	3.8	M4x0.7	Ø3.5
SBI25 HL	36	48	92	5.5	35	35	M6	6	70	12	30.5	6	12	5	5.5	M6x0.75	Ø3.5
SBI25 HLL	36	48	108	5.5	35	50	M6	6	86	12	30.5	6	12	5	5.5	M6x0.75	Ø3.5
SBI30 HL	42	60	107.6	7	40	40	M8	8	79.6	12	35	8.5	12	7.8	5	M6x0.75	Ø5.7
SBI30 HLL	42	60	131.6	7	40	60	M8	8	103.6	12	35	8.5	12	7.8	5	M6x0.75	Ø5.7
SBI35 HL	48	70	124.6	7.5	50	50	M8	8	94.6	15	40.5	8	12	8	6	M6x0.75	Ø5.7
SBI35 HLL	48	70	152.6	7.5	50	72	M8	8	122.6	15	40.5	8	12	8	6	M6x0.75	Ø5.7
SBI45 HL	60	86	142	9	60	60	M10	10	108	17	51	10.5	13.5	9.3	6.5	PT1/8	Ø5.7
SBI45 HLL	60	86	174	9	60	80	M10	10	140	17	51	10.5	13.5	9.3	6.5	PT1/8	Ø5.7
SBI55 HL	70	100	172.4	12	75	75	M12	12	131	21	58	12	13	12	8	PT1/8	Ø8.7
SBI55 HLL	70	100	211.8	12	75	95	M12	12	170.4	21	58	12	13	12	8	PT1/8	Ø8.7

导轨尺寸 Rail dimension										基本额定载荷 Basic load rating [kN]		容许静力矩 Permissible static moment [kN·m]			质量 Mass	
W1	W2	H1	F	螺栓孔 Bolt hole			G	导轨最大长度 Max length of rail L0	C	Co	Mro	Mpo	Myo	滑块 Block [kg]	导轨 Rail [kg/m]	
				d	D	h										
15	9.5	13	60	4.5	7.5	5.5	20	3000	14.1	24.1	0.16	0.17	0.17	0.19	1.3	
15	9.5	13	60	4.5	7.5	5.5	20	3000	12.3	18.3	0.13	0.08	0.08	0.15	1.3	
15	9.5	13	60	4.5	7.5	5.5	20	3000	17.1	31.7	0.21	0.29	0.29	0.26	1.3	
23	12.5	20	60	7	11	9	20	4000	31.5	52.1	0.56	0.56	0.56	0.69	3	
23	12.5	20	60	7	11	9	20	4000	36.7	64.4	0.69	0.84	0.84	0.85	3	
28	16	23	80	9	14	12	20	4000	42.8	65.4	0.85	0.77	0.77	1.04	4.25	
28	16	23	80	9	14	12	20	4000	51.3	84.7	1.10	1.30	1.30	1.37	4.25	
34	18	26	80	9	14	12	20	4000	59.5	89.1	1.42	1.28	1.28	1.56	6.02	
34	18	26	80	9	14	12	20	4000	71.3	115.3	1.83	2.12	2.12	2.04	6.02	
45	20.5	32	105	14	20	17	22.5	4000	79.2	116.3	2.48	1.90	1.90	2.80	9.77	
45	20.5	32	105	14	20	17	22.5	4000	94.8	150.5	3.21	3.14	3.14	3.69	9.77	
53	23.5	38	120	16	23	20	30	4000	127.3	181.8	4.81	2.97	2.97	4.42	13.72	
53	23.5	38	120	16	23	20	30	4000	147.9	224.5	5.95	4.78	4.78	5.82	13.72	

- ① C (基本额定动载荷), Co (基本额定静载荷)  
C (Basic dynamic load rating), Co (Basic static load rating)
- \*Q2: 侧面注油部件的注入孔未留, 以防止异物进入导轨系统内部。
- ② 在您订购侧面注油部件时, 我们会自行开孔。  
\*Q2: The hole of side grease nipple is not made to prevent a foreign substance from going into inside.  
When you order the side grease nipple, we build it by ourselves.