

SBI-SL/SLL

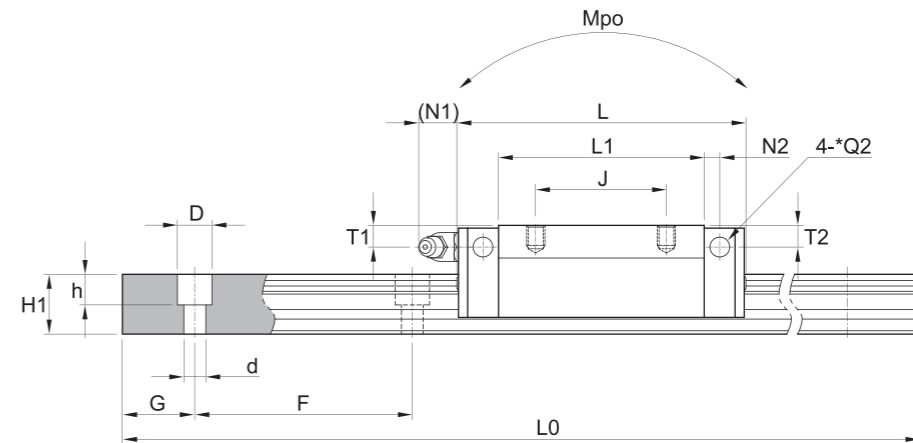
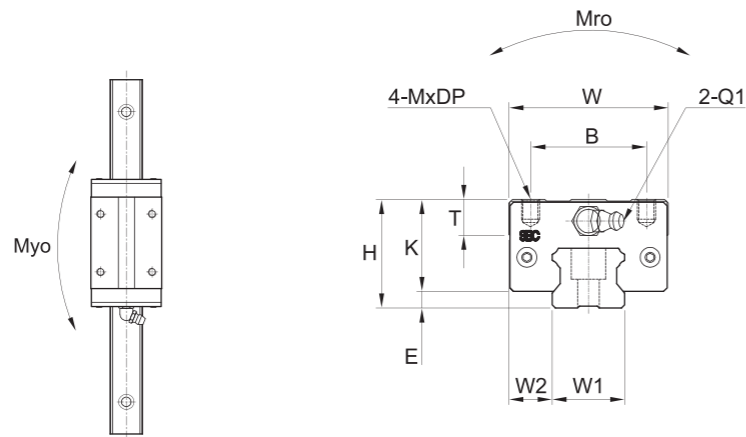

(单位Unit : mm)

| 型号<br>Model | 安装尺寸<br>Mounting dimension |     |       |     | 滑块尺寸<br>Block dimensions   |     |     |    |       |     |      |                        |      |      |     |         |      |
|-------------|----------------------------|-----|-------|-----|----------------------------|-----|-----|----|-------|-----|------|------------------------|------|------|-----|---------|------|
|             | H                          | W   | L     | E   | 安装螺纹孔<br>Mounting tap hole |     |     |    | L1    | T±1 | K    | 注油部件<br>Grease fitting |      |      |     |         |      |
|             |                            |     |       |     | B                          | J   | M   | DP |       |     |      | T1                     | N1   | T2   | N2  | Q1      | *Q2  |
| SBI15 SL    | 28                         | 34  | 63.8  | 3   | 26                         | 26  | M4  | 5  | 45.2  | 10  | 25   | 8.5                    | 5.5  | 7.8  | 3.8 | M4x0.7  | Ø3.5 |
| SBI15 SLL   | 28                         | 34  | 79.4  | 3   | 26                         | 34  | M4  | 5  | 60.8  | 10  | 25   | 8.5                    | 5.5  | 7.8  | 3.8 | M4x0.7  | Ø3.5 |
| SBI20 SL    | 30                         | 44  | 78.8  | 4.6 | 32                         | 36  | M5  | 5  | 56.8  | 10  | 25.4 | 6                      | 12   | 5.8  | 5   | M6x0.75 | Ø3.5 |
| SBI20 SLL   | 30                         | 44  | 96.4  | 4.6 | 32                         | 50  | M5  | 5  | 74.4  | 10  | 25.4 | 6                      | 12   | 5.8  | 5   | M6x0.75 | Ø3.5 |
| SBI25 SL    | 40                         | 48  | 92    | 5.5 | 35                         | 35  | M6  | 8  | 70    | 16  | 34.5 | 10                     | 12   | 9    | 5   | M6x0.75 | Ø3.5 |
| SBI25 SLL   | 40                         | 48  | 108   | 5.5 | 35                         | 50  | M6  | 8  | 86    | 16  | 34.5 | 10                     | 12   | 9    | 5   | M6x0.75 | Ø3.5 |
| SBI30 SL    | 45                         | 60  | 107.6 | 7   | 40                         | 40  | M8  | 10 | 79.6  | 12  | 38   | 11.5                   | 12   | 10.8 | 5   | M6x0.75 | Ø5.7 |
| SBI30 SLL   | 45                         | 60  | 131.6 | 7   | 40                         | 60  | M8  | 10 | 103.6 | 12  | 38   | 11.5                   | 12   | 10.8 | 5   | M6x0.75 | Ø5.7 |
| SBI35 SL    | 55                         | 70  | 124.6 | 7.5 | 50                         | 50  | M8  | 10 | 94.6  | 15  | 47.5 | 15                     | 12   | 15   | 6   | M6x0.75 | Ø5.7 |
| SBI35 SLL   | 55                         | 70  | 152.6 | 7.5 | 50                         | 72  | M8  | 10 | 122.6 | 15  | 47.5 | 15                     | 12   | 15   | 6   | M6x0.75 | Ø5.7 |
| SBI45 SL    | 70                         | 86  | 142   | 9   | 60                         | 60  | M10 | 13 | 108   | 17  | 61   | 20.5                   | 13.5 | 19.3 | 6.5 | PT1/8   | Ø5.7 |
| SBI45 SLL   | 70                         | 86  | 174   | 9   | 60                         | 80  | M10 | 13 | 140   | 17  | 61   | 20.5                   | 13.5 | 19.3 | 6.5 | PT1/8   | Ø5.7 |
| SBI55 SL    | 80                         | 100 | 172.4 | 12  | 75                         | 75  | M12 | 18 | 131   | 21  | 68   | 22                     | 13   | 22   | 8   | PT1/8   | Ø8.7 |
| SBI55 SLL   | 80                         | 100 | 211.8 | 12  | 75                         | 95  | M12 | 18 | 170.4 | 21  | 68   | 22                     | 13   | 22   | 8   | PT1/8   | Ø8.7 |
| SBI65 SL    | 90                         | 126 | 219.8 | 19  | 76                         | 70  | M16 | 16 | 170.4 | 26  | 71   | 14                     | 13   | 14   | 10  | PT1/8   | Ø8.7 |
| SBI65 SLL   | 90                         | 126 | 272.2 | 19  | 76                         | 120 | M16 | 16 | 222.8 | 26  | 71   | 14                     | 13   | 14   | 10  | PT1/8   | Ø8.7 |

| 导轨尺寸<br>Rail dimension |      |      |     |                  |     |     |      |                                 |       | 基本额定载荷<br>Basic load rating [kN] |       | 容许静力矩<br>Permissible static moment [kN·m] |      |                  | 质量<br>Mass        |  |
|------------------------|------|------|-----|------------------|-----|-----|------|---------------------------------|-------|----------------------------------|-------|---|------|------------------|-------------------|--|
| W1                     | W2   | H1   | F   | 螺栓孔<br>Bolt hole |     |     | G    | 导轨最大长度<br>Max length of rail L0 | C     | Co                               | Mro   | Mpo                                       | Myo  | 滑块<br>Block [kg] | 导轨<br>Rail [kg/m] |  |
|                        |      |      |     | d                | D   | h   |      |                                 |       |                                  |       |   |      |                  |                   |  |
| 15                     | 9.5  | 13   | 60  | 4.5              | 7.5 | 5.5 | 20   | 3000                            | 14.1  | 24.1                             | 0.16  | 0.17                                      | 0.17 | 0.19             | 1.3               |  |
| 15                     | 9.5  | 13   | 60  | 4.5              | 7.5 | 5.5 | 20   | 3000                            | 17.1  | 31.7                             | 0.21  | 0.29                                      | 0.29 | 0.26             | 1.3               |  |
| 20                     | 12   | 16.5 | 60  | 6                | 9.5 | 8.5 | 20   | 4000                            | 22.2  | 38.2                             | 0.36  | 0.33                                      | 0.33 | 0.41             | 2.2               |  |
| 20                     | 12   | 16.5 | 60  | 6                | 9.5 | 8.5 | 20   | 4000                            | 27.9  | 50                               | 0.47  | 0.56                                      | 0.56 | 0.54             | 2.2               |  |
| 23                     | 12.5 | 20   | 60  | 7                | 11  | 9   | 20   | 4000                            | 31.5  | 52.1                             | 0.56  | 0.56                                      | 0.56 | 0.69             | 3                 |  |
| 23                     | 12.5 | 20   | 60  | 7                | 11  | 9   | 20   | 4000                            | 36.7  | 64.4                             | 0.69  | 0.84                                      | 0.84 | 0.85             | 3                 |  |
| 28                     | 16   | 23   | 80  | 9                | 14  | 12  | 20   | 4000                            | 42.8  | 65.4                             | 0.85  | 0.77                                      | 0.77 | 1.04             | 4.25              |  |
| 28                     | 16   | 23   | 80  | 9                | 14  | 12  | 20   | 4000                            | 51.3  | 84.7                             | 1.10  | 1.30                                      | 1.30 | 1.37             | 4.25              |  |
| 34                     | 18   | 26   | 80  | 9                | 14  | 12  | 20   | 4000                            | 59.5  | 89.1                             | 1.42  | 1.28                                      | 1.28 | 1.56             | 6.02              |  |
| 34                     | 18   | 26   | 80  | 9                | 14  | 12  | 20   | 4000                            | 71.3  | 115.3                            | 1.83  | 2.12                                      | 2.12 | 2.04             | 6.02              |  |
| 45                     | 20.5 | 32   | 105 | 14               | 20  | 17  | 22.5 | 4000                            | 79.2  | 116.3                            | 2.48  | 1.90                                      | 1.90 | 2.80             | 9.77              |  |
| 45                     | 20.5 | 32   | 105 | 14               | 20  | 17  | 22.5 | 4000                            | 94.8  | 150.5                            | 3.21  | 3.14                                      | 3.14 | 3.69             | 9.77              |  |
| 53                     | 23.5 | 38   | 120 | 16               | 23  | 20  | 30   | 4000                            | 127.3 | 181.8                            | 4.81  | 2.97                                      | 2.97 | 4.42             | 13.72             |  |
| 53                     | 23.5 | 38   | 120 | 16               | 23  | 20  | 30   | 4000                            | 147.9 | 224.5                            | 5.95  | 4.78                                      | 4.78 | 5.82             | 13.72             |  |
| 63                     | 31.5 | 53   | 150 | 18               | 26  | 22  | 35   | 4000                            | 188.3 | 261.7                            | 8.24  | 5.57                                      | 5.57 | 9.1              | 23.17             |  |
| 63                     | 31.5 | 53   | 150 | 18               | 26  | 22  | 35   | 4000                            | 232.5 | 354.1                            | 11.15 | 9.86                                      | 9.86 | 11.98            | 23.17             |  |

① C (基本额定动载荷), Co (基本额定静载荷)  
C (Basic dynamic load rating), Co (Basic static load rating)  
\*Q2: 侧面注油部件的注入孔未留, 以防止异物进入导轨系统内部。  
② 在您订购侧面注油部件时, 我们会自行开孔。  
\*Q2: The hole of side grease nipple is not made to prevent a foreign substance from going into inside.  
When you order the side grease nipple, we build it by ourselves.